

LEGEND	
	= NEW FOUL WATER DRAIN WITH DIRECTION OF FLOW. ALL PIPES TO BE VITRIFIED CLAY TO BS EN 295:1991 WITH FLEXIBLE COUPLINGS UNLESS NOTED OTHERWISE.
	= NEW SURFACE WATER DRAIN WITH DIRECTION OF FLOW. ALL PIPES TO BE VITRIFIED CLAY TO BS EN 295:1991 WITH FLEXIBLE COUPLINGS UNLESS NOTED OTHERWISE.
TRG	= TRAPPED ROAD GULLY WITH RODDING ACCSES, 150 DIA. PIPE AT MIN. 1:100 DISCHARGING TO SWMH OR 'Y' CONNECTION TO DRAIN.
BG	= BIRCO 100 IN LINE SIDE TRAP OUTFALL WITH 150 DIA. PIPE AT MIN 1:100 TO MANHOLE OR 'Y' CONNECTION TO DRAIN OR CULVERT.
RWP	= RAINWATER PIPE CONNECTIONS TO BE MADE VIA A 90° REST BEND SET IN CONCRETE.
SVP	= Ø100 SOIL AND VENT PIPE. TO BE CONNECTED TO A 90° REST BEND SET IN CONCRETE.
SS	= Ø100 STUB STACK. TO BE CONNECTED TO A 90° REST BEND SET IN CONCRETE.
TG	= Ø100 TRAPPED GULLY. TO BE CONNECTED TO A 90° REST BEND SET IN CONCRETE.

PIPE BEDDING AND BACKFILLING REQUIREMENTS		
LOCATION	DEPTH OF COVER	BEDDING TYPE
LANDSCAPED AREAS	< 0.6m	CONCRETE
LANDSCAPED AREAS	> 0.6m	GRANULAR
ROADS AND PAVING	< 1.2m	CONCRETE
ROADS AND PAVING	> 1.2m	GRANULAR
UNDER BUILDING GROUND BEARING SLAB	< 0.6m	CONCRETE
UNDER BUILDING GROUND BEARING SLAB	> 0.6m	GRANULAR
UNDER BUILDING SUSPENDED GROUND FLOOR	-	GRANULAR

NOTE - F.W. DRAINS THAT DO NOT HAVE A W.C. CONNECTED ARE TO HAVE A MINIMUM FALL OF 1:40

THE ADOPTED AREA OF ACCESS ROAD IS TO DRAIN INTO THE EXISTING STORM SEWER IN EDISON BELL WAY. SEE ENCON DRAWINGS

THE COVER LEVEL OF THE EXISTING CHAMBER IS TO BE RAISED TO MATCH THE PROPOSED INCREASED GROUND LEVEL. THE DETAILS ARE TO BE AGREED WITH ANGLIAN WATER

NOTE - F.W. DRAINS THAT DO NOT HAVE A W.C. CONNECTED ARE TO HAVE A MINIMUM FALL OF 1:40

THE COVER LEVEL OF THE EXISTING CHAMBER IS TO BE LOWERED TO MATCH THE PROPOSED REDUCED GROUND LEVEL. THE DETAILS ARE TO BE AGREED WITH ANGLIAN WATER

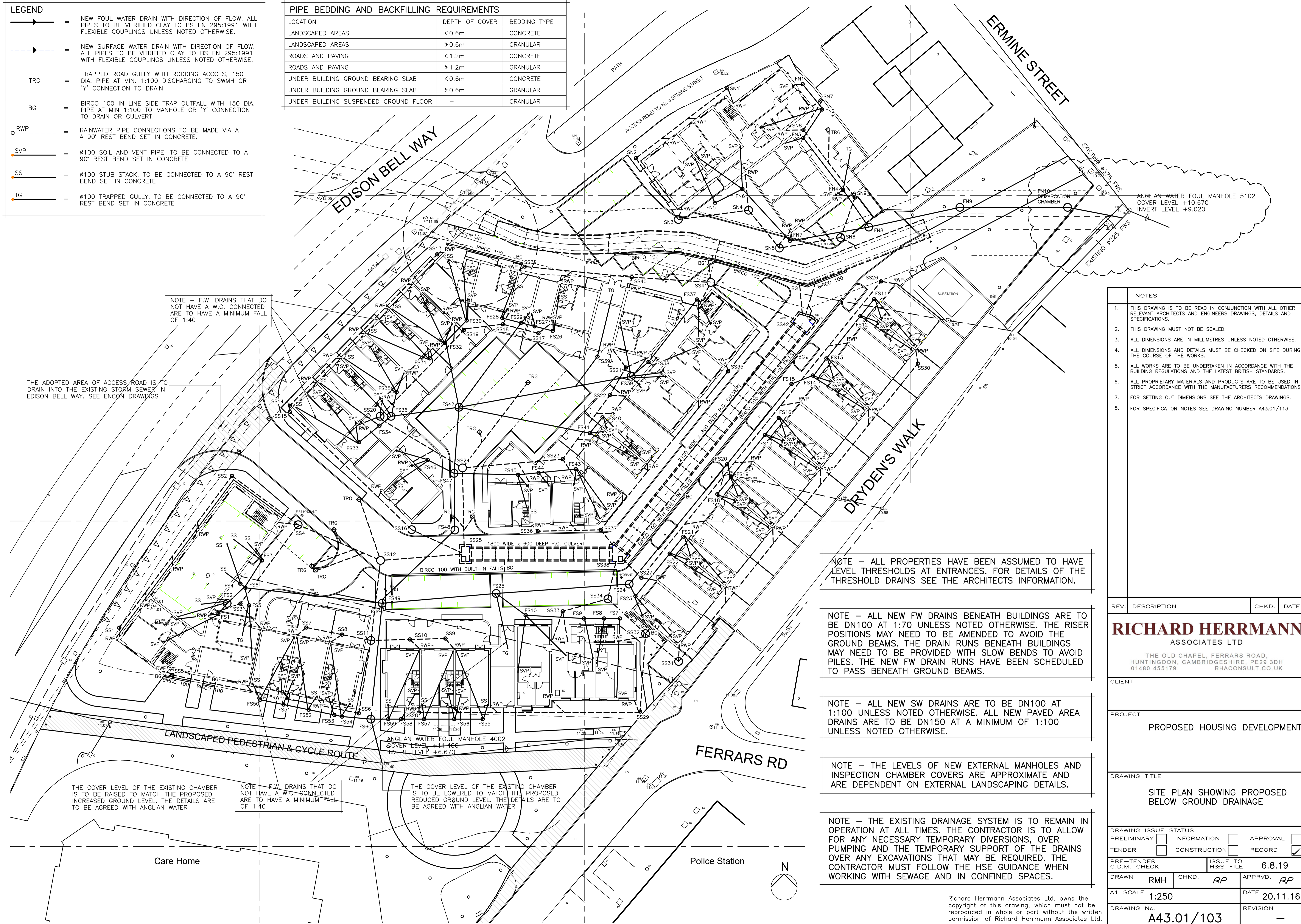

- | NOTES | |
|-------|--|
| 1. | THIS DRAWING IS TO BE READ IN CONJUNCTION WITH ALL OTHER RELEVANT ARCHITECTS AND ENGINEERS DRAWINGS, DETAILS AND SPECIFICATIONS. |
| 2. | THIS DRAWING MUST NOT BE SCALED. |
| 3. | ALL DIMENSIONS ARE IN MILLIMETRES UNLESS NOTED OTHERWISE. |
| 4. | ALL DIMENSIONS AND DETAILS MUST BE CHECKED ON SITE DURING THE COURSE OF THE WORKS. |
| 5. | ALL WORKS ARE TO BE UNDERTAKEN IN ACCORDANCE WITH THE BUILDING REGULATIONS AND THE LATEST BRITISH STANDARDS. |
| 6. | ALL PROPRIETARY MATERIALS AND PRODUCTS ARE TO BE USED IN STRICT ACCORDANCE WITH THE MANUFACTURERS RECOMMENDATIONS. |
| 7. | FOR SETTING OUT DIMENSIONS SEE THE ARCHITECTS DRAWINGS. |
| 8. | FOR SPECIFICATION NOTES SEE DRAWING NUMBER A43.01/113. |

REV.	DESCRIPTION	CHKD.	DATE
RICHARD HERRMANN ASSOCIATES LTD			
THE OLD CHAPEL, FERRARS ROAD, HUNTINGDON, CAMBRIDGESHIRE, PE29 3DH 01480 455179 RHACONSULT.CO.UK			
CLIENT			
PROJECT			
PROPOSED HOUSING DEVELOPMENT			
DRAWING TITLE			
SITE PLAN SHOWING PROPOSED BELOW GROUND DRAINAGE			
DRAWING ISSUE STATUS			
PRELIMINARY	<input type="checkbox"/>	INFORMATION	<input type="checkbox"/>
TENDER	<input type="checkbox"/>	CONSTRUCTION	<input type="checkbox"/>
		APPROVAL	<input type="checkbox"/>
		RECORD	<input checked="" type="checkbox"/>
PRE-TENDER C.D.M. CHECK	ISSUE TO H&S FILE	6.8.19	
DRAWN RMH	CHKD. RP	APPRVD. RP	
A1 SCALE 1:250	DATE 20.11.16		
DRAWING No. A43.01/103	REVISION -		

Richard Herrmann Associates Ltd. owns the copyright of this drawing, which must not be reproduced in whole or part without the written permission of Richard Herrmann Associates Ltd.